

STATE OF CALIFORNIA
DEPARTMENT OF TRANSPORTATION

GEOMETRIC APPROVAL DRAWINGS FOR
THEODORE INTERCHANGE ON
STATE ROUTE 60

IN RIVERSIDE COUNTY
IN THE CITY OF MORENO VALLEY
AT THEODORE STREET

CALIFORNIA STATE POLYTECHNIC UNIVERSITY, POMONA
SENIOR PROJECT 2014-2015

Dist	COUNTY	ROUTE	POST MILES TOTAL PROJECT	SHEET No.	TOTAL SHEETS
08	RVD	60		1	2



ALTERNATIVE 3
DIVERGING DIAMOND

PROJECT MANAGERS	SAMUEL EKSTRAND
	RACHEL YAZAWA
	BIANCA ARGUETA
	KRISTINA BILLEDI
PROJECT ENGINEERS	WILLIAM CHENOWETH
	ROMAN GUTIERREZ
	DIANE JOHANNES
	ANTHONY KREEGER
	KRISTINE MACALMA
	LESLIE SITU
	NICOLLE SPANN
	CHARLES TRUONG
CAMERON WEISS	

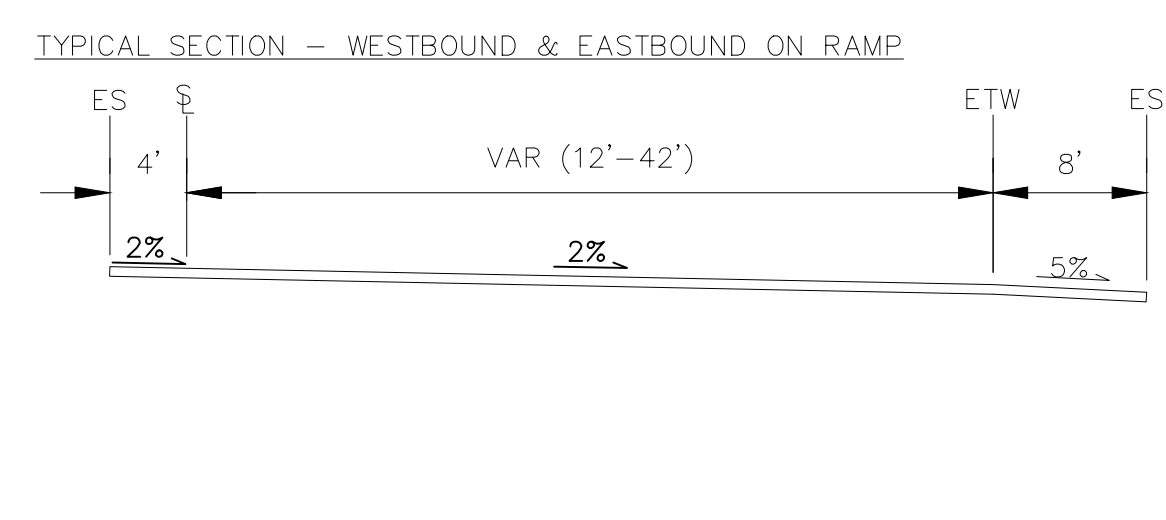
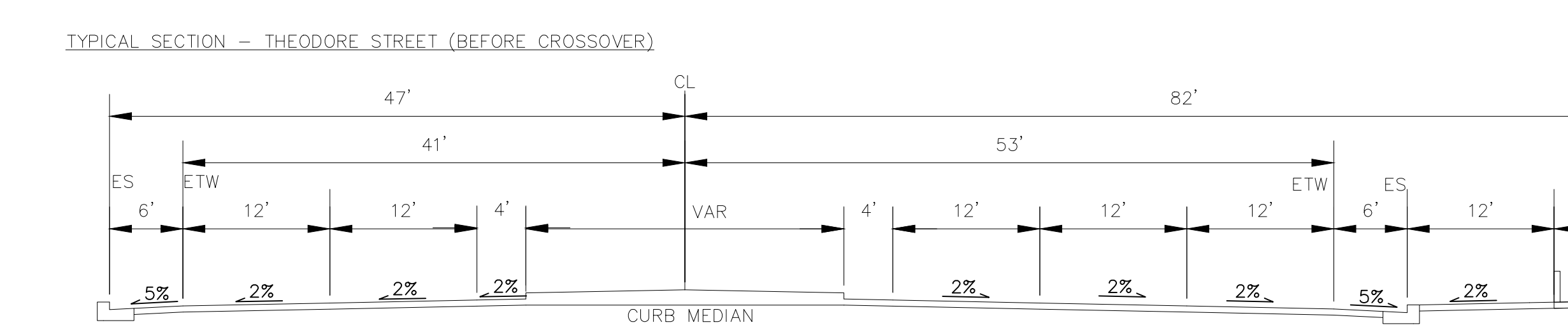
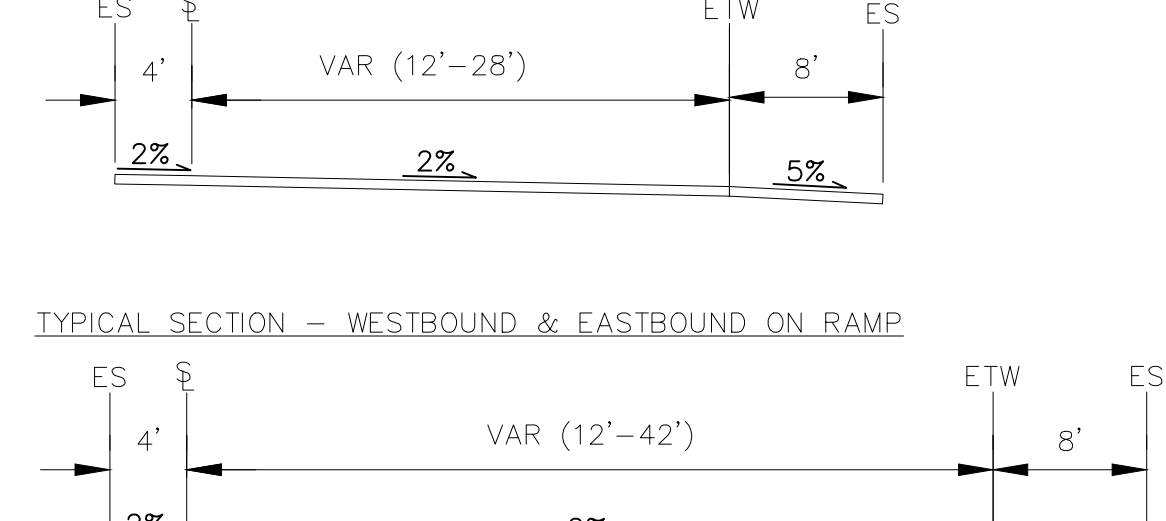
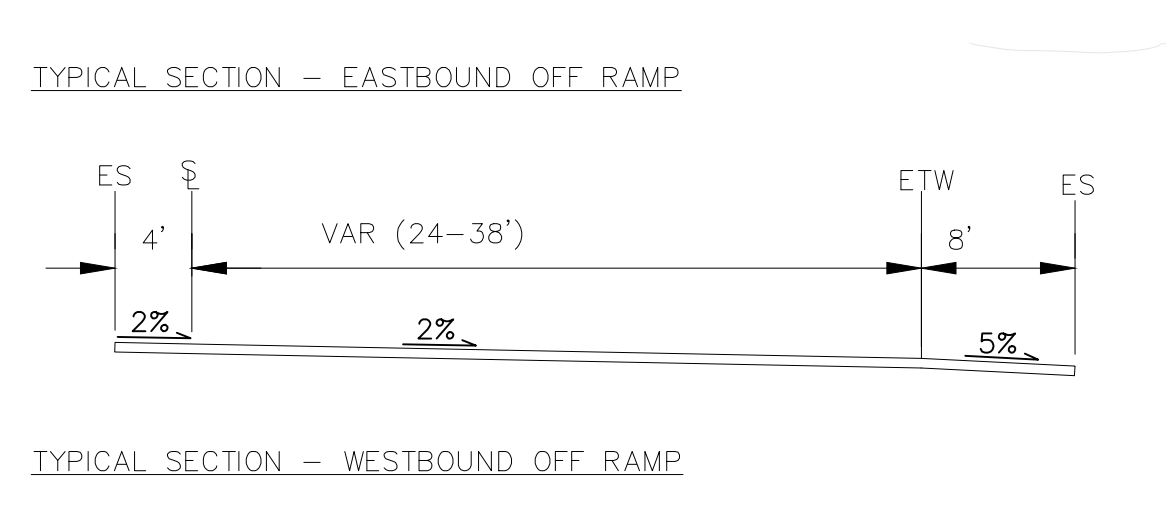
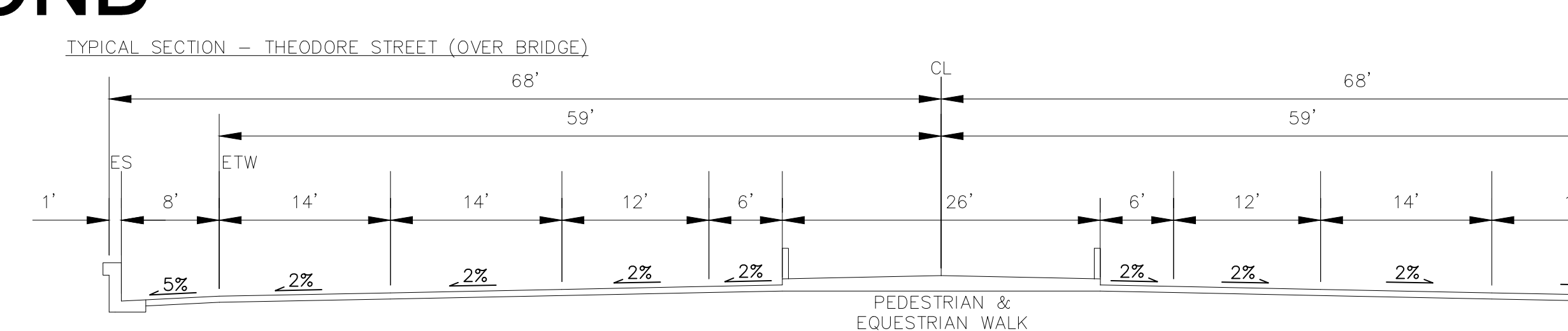
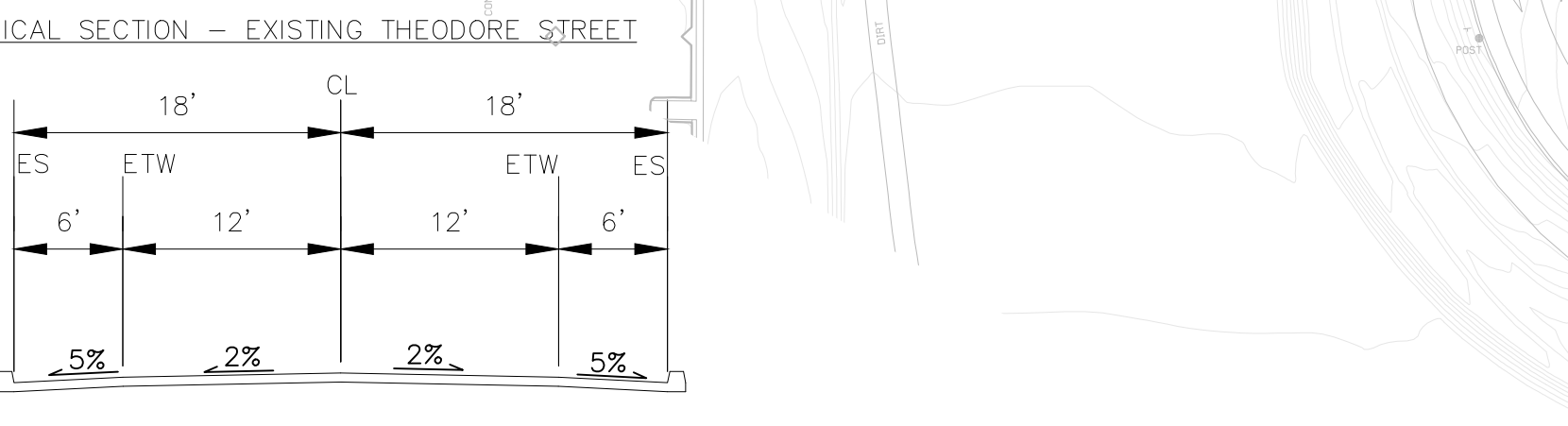
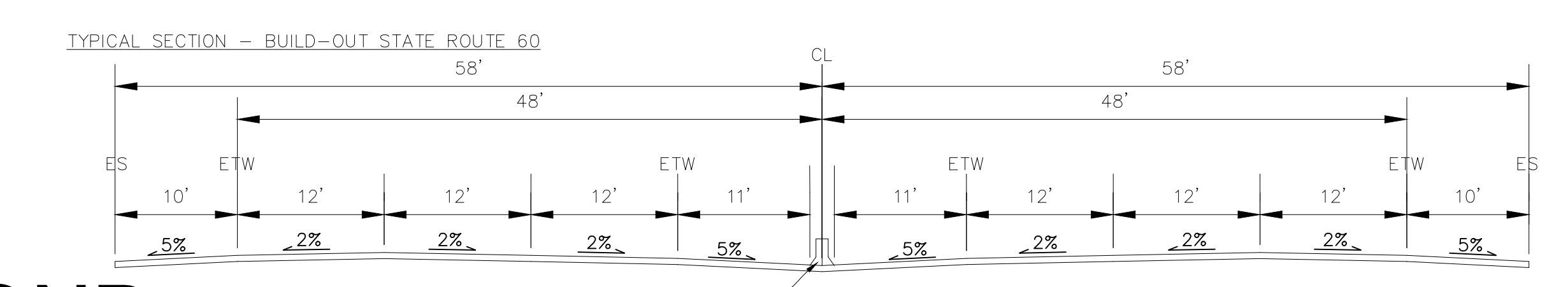
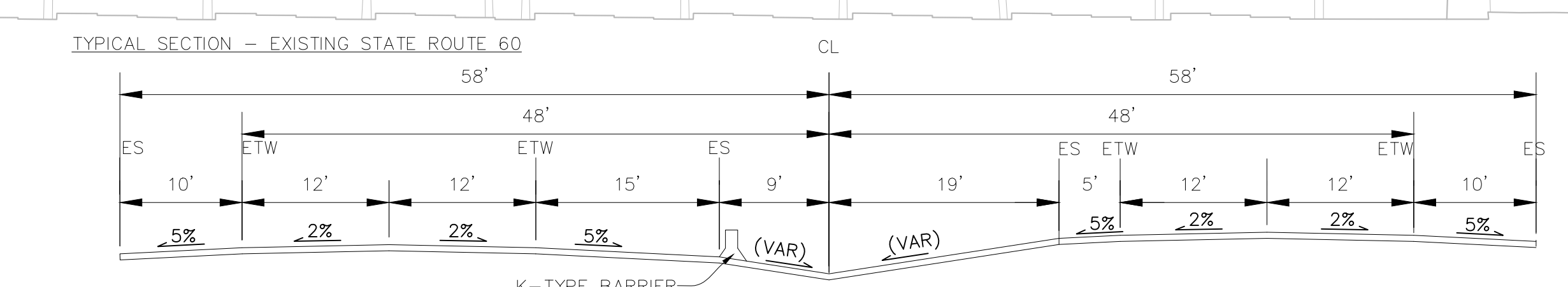

SCALE 1"=80'

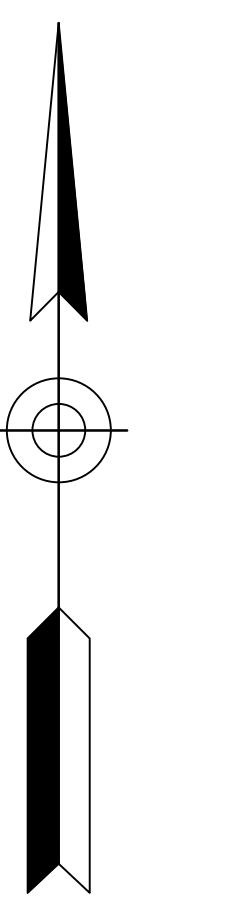

Curve #	R	Δ	T	L
C1	550.00'	28°27'00"	129.27'	253.92'
C2	336.00'	40°09'30"	122.68'	235.25'
C3	236.00'	29°32'45"	86.77'	181.50'
C4	1024.00'	21°03'02"	190.26'	376.22'
C5	3000.00'	3°11'29"	83.57'	167.10'
C6	574.00'	26°19'34"	134.24'	263.74'
C7	350.00'	28°55'59"	83.81'	164.53'
C8	1500.00'	22°17'40"	295.57'	583.67'
C9	566.88'	23°10'41"	81.17'	174.21'
C10	3486.48'	4°52'20"	150.28'	300.38'
C11	2895.98'	6°07'13"	160.17'	320.03'
C12	2819.72'	3°41'14"	90.76'	181.46'
C13	324.00'	59°00'01"	183.31'	333.64'
C14	224.00'	43°02'03"	86.31'	166.24'
C15	224.00'	66°08'01"	145.84'	286.55'
C16	238.00'	80°15'04"	200.56'	333.35'
C17	210.00'	26°58'41"	50.36'	98.85'
C18	206.00'	17°52'35"	32.41'	64.29'
C19	204.00'	21°42'23"	32.14'	77.34'
C20	204.00'	15°49'23"	28.35'	56.34'
C21	210.00'	14°07'59"	26.04'	51.81'
C22	204.00'	16°17'56"	29.21'	58.03'
C23	206.00'	23°18'40"	42.49'	83.81'
C24	206.00'	17°24'42"	31.54'	62.60'
C25	224.00'	66°59'28"	148.24'	281.90'
C26	236.00'	75°15'06"	183.46'	312.59'
C27	224.00'	49°17'59"	103.32'	193.62'
C28	224.00'	37°42'12"	75.05'	145.73'
C29	3000.00'	6°44'11"	176.56'	352.71'
C30	850.00'	3°43'39"	27.66'	55.30'

SCALE 1"=150'

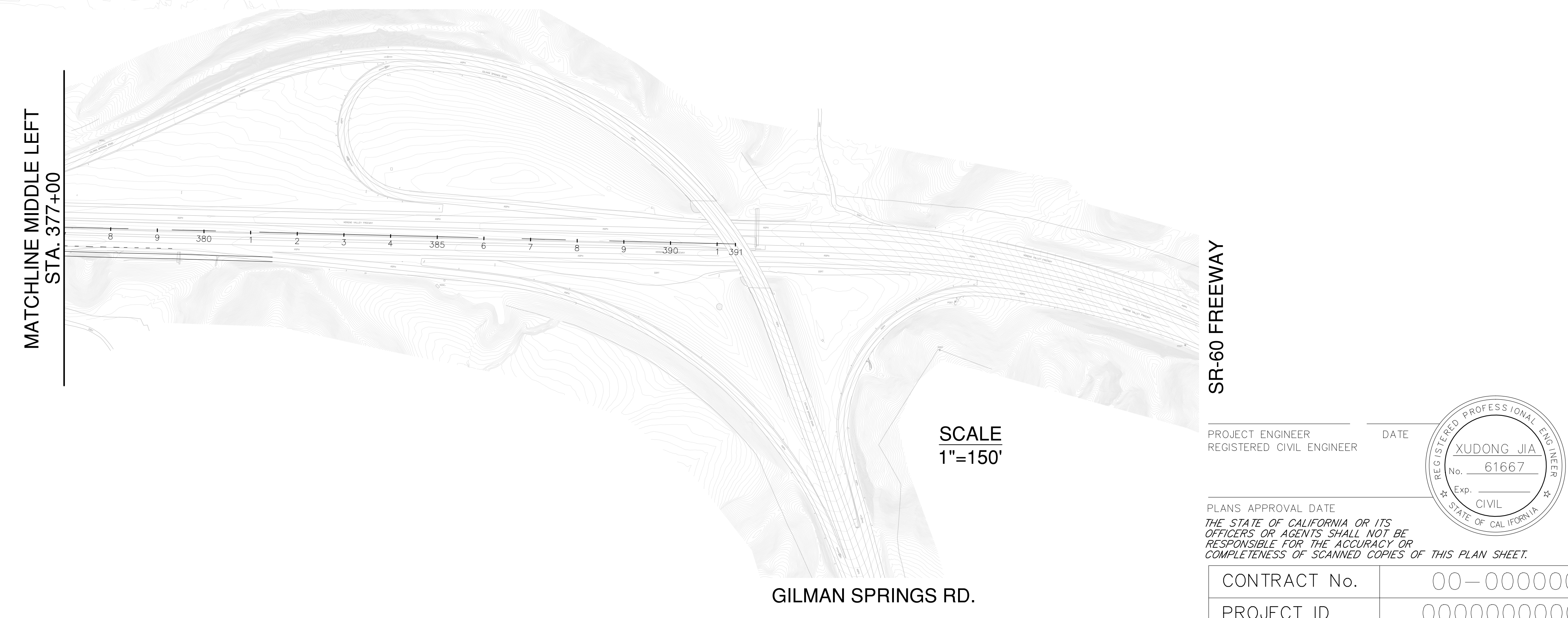

PROJECT ENGINEER REGISTERED CIVIL ENGINEER DATE

MUDDING JIA No. 61667 CIVIL ENGINEER STATE OF CALIFORNIA

PLANS APPROVAL DATE THE STATE OF CALIFORNIA OR ITS OFFICERS OR AGENTS SHALL NOT BE RESPONSIBLE FOR THE ACCURACY OR COMPLETENESS OF SCANNED COPIES OF THIS PLAN SHEET.

CONTRACT No. 00-000000 PROJECT ID 0000000000

PLAN VIEW, CURVE DATA, CROSS-SECTIONS UNIT 0000 PROJECT NUMBER & PHASE 0000000001

PROFILE - THEODORE STREET

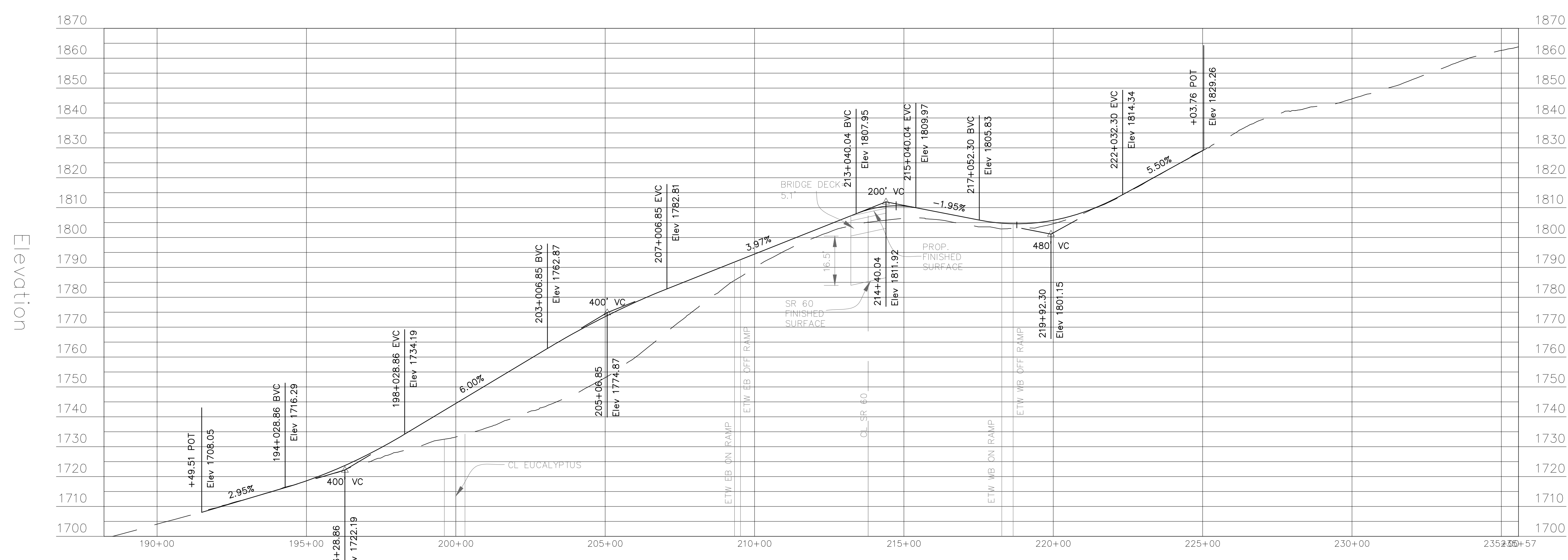

SCALE
Horiz. 1"=200'
Vert. 1"=20'

SUPERELEVATION - WESTBOUND ON-RAMP

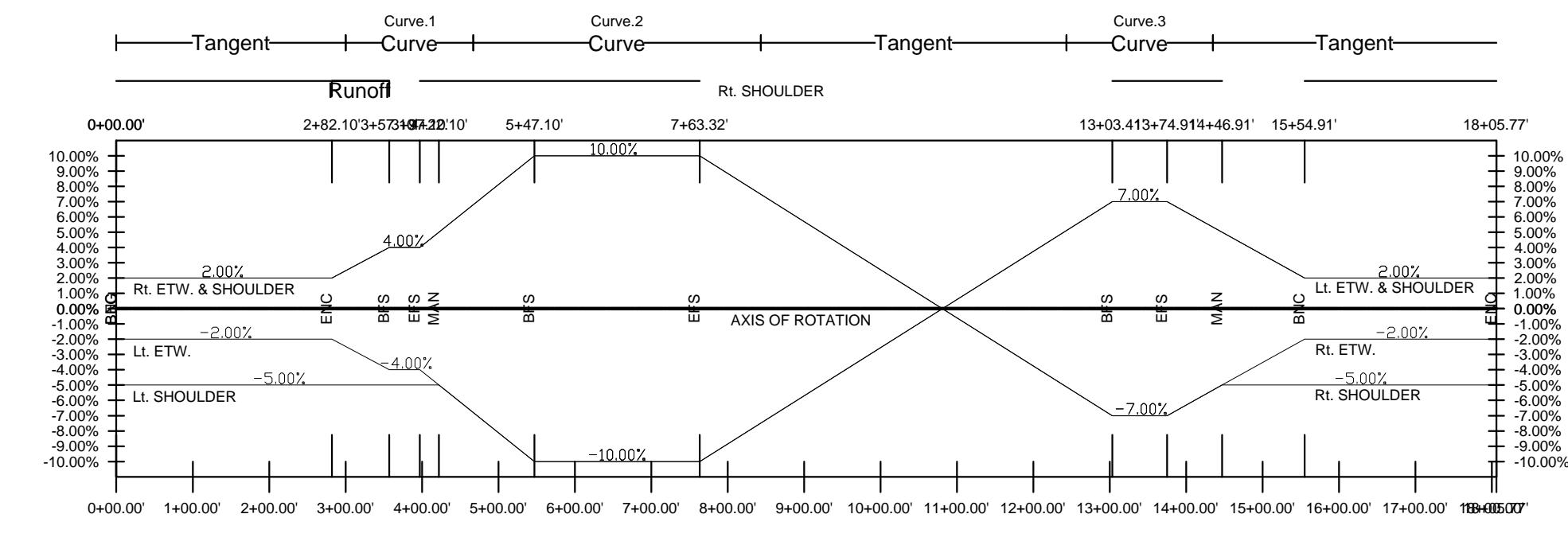

PROFILE - WESTBOUND ON-RAMP

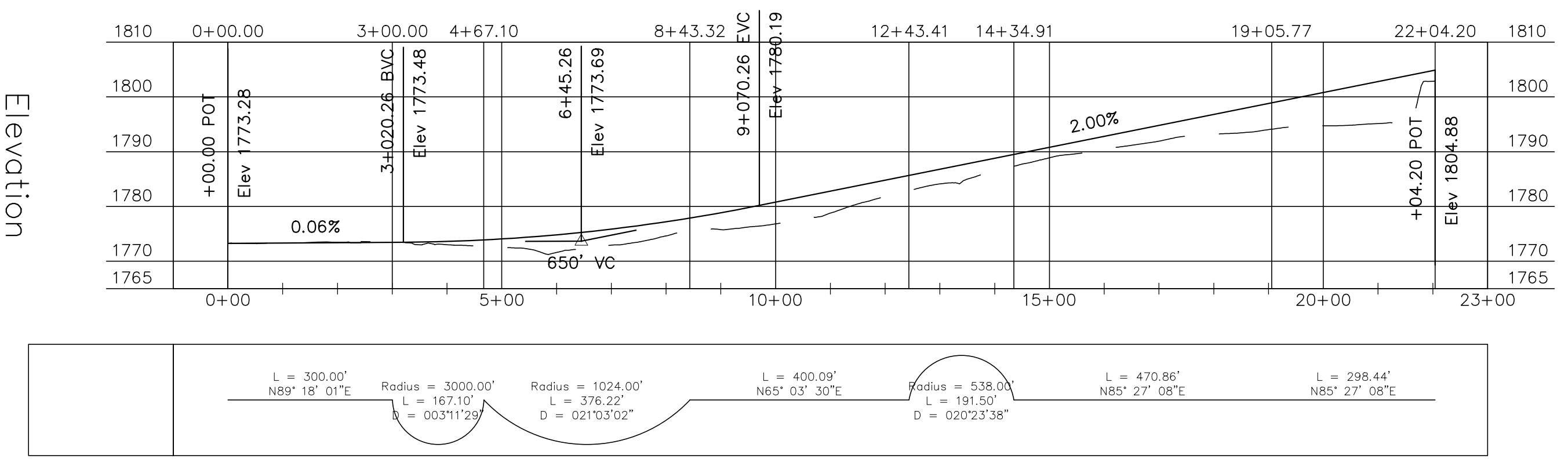

SCALE
Horiz. 1"=200'
Vert. 1"=20'

SUPERELEVATION - WESTBOUND OFF-RAMP

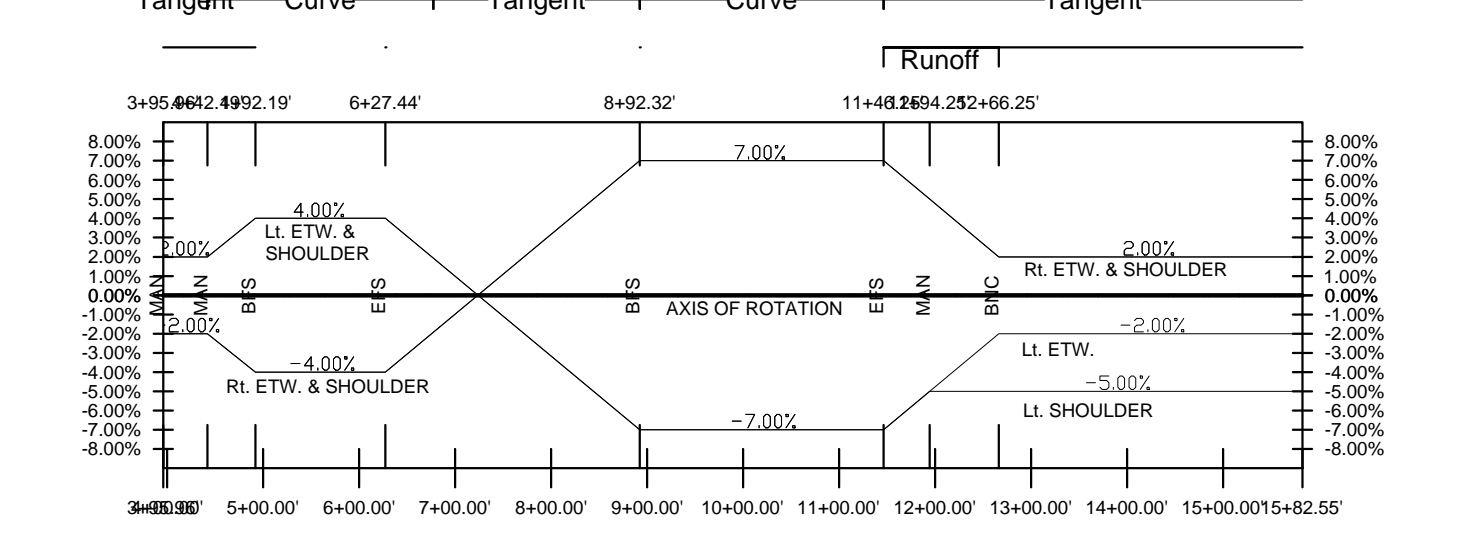

PROFILE - WESTBOUND OFF-RAMP

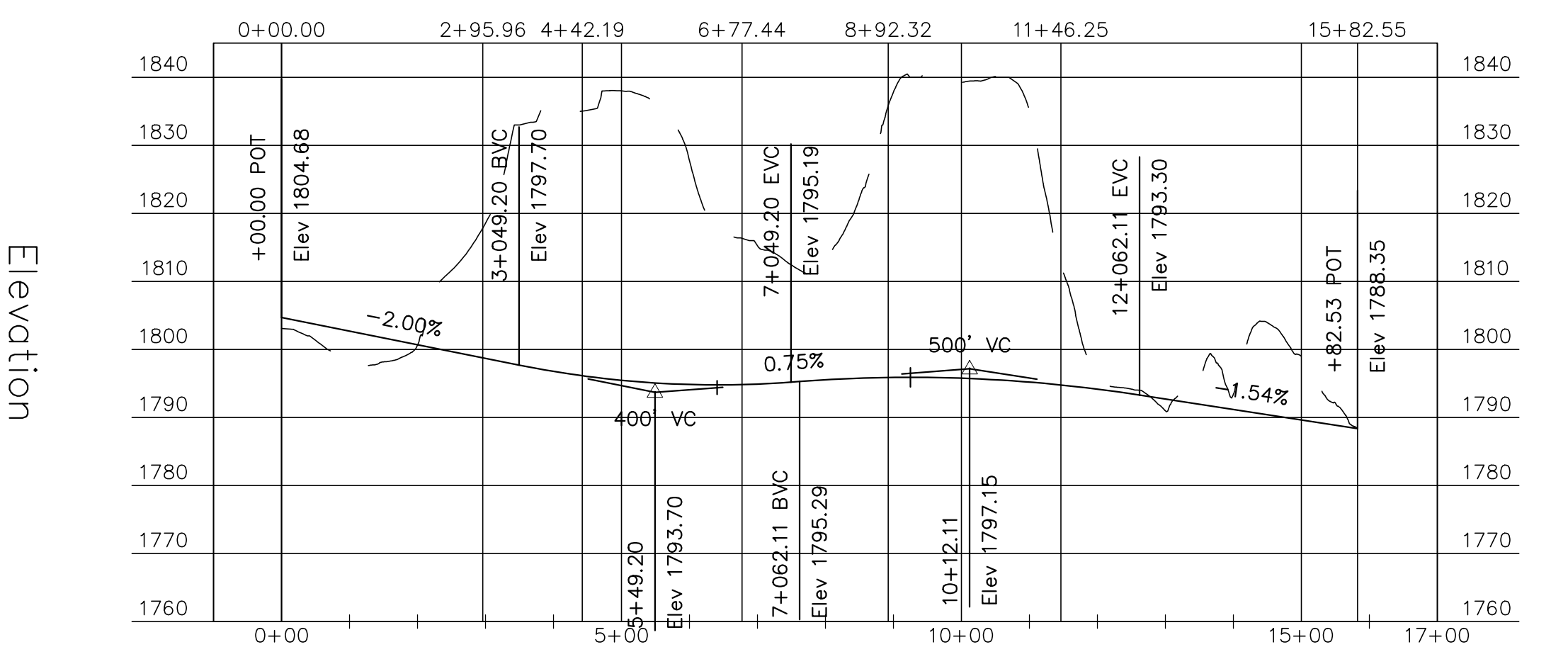

SCALE
Horiz. 1"=200'
Vert. 1"=20'

PROFILE - STATE ROUTE 60 (EXISTING)

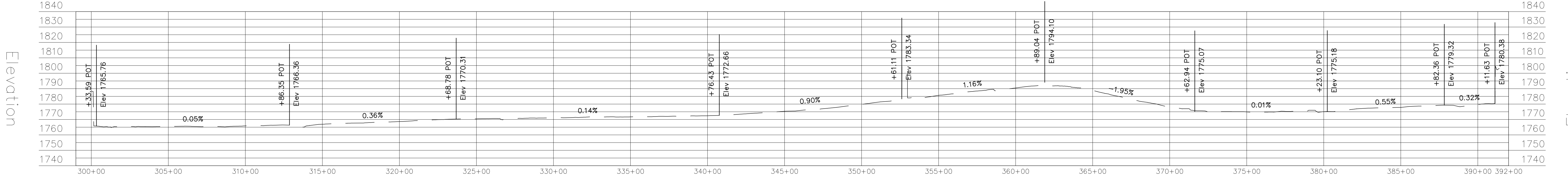

SCALE
Horiz. 1"=300'
Vert. 1"=30'

SUPERELEVATION - EASTBOUND OFF-RAMP

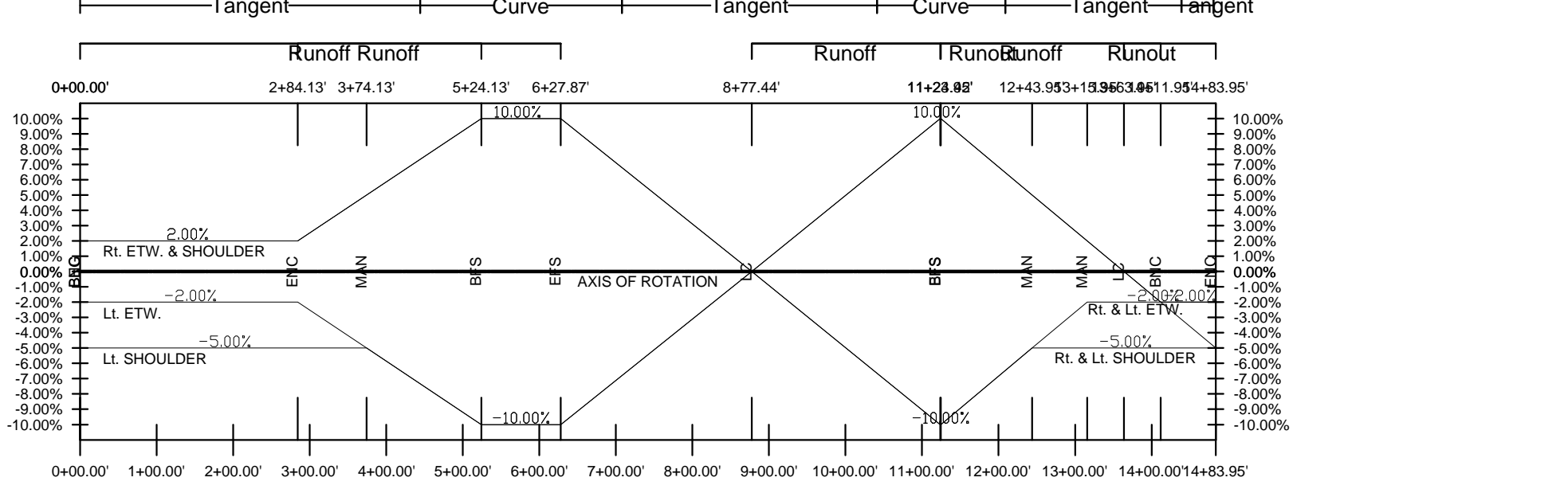

PROFILE - EASTBOUND OFF-RAMP

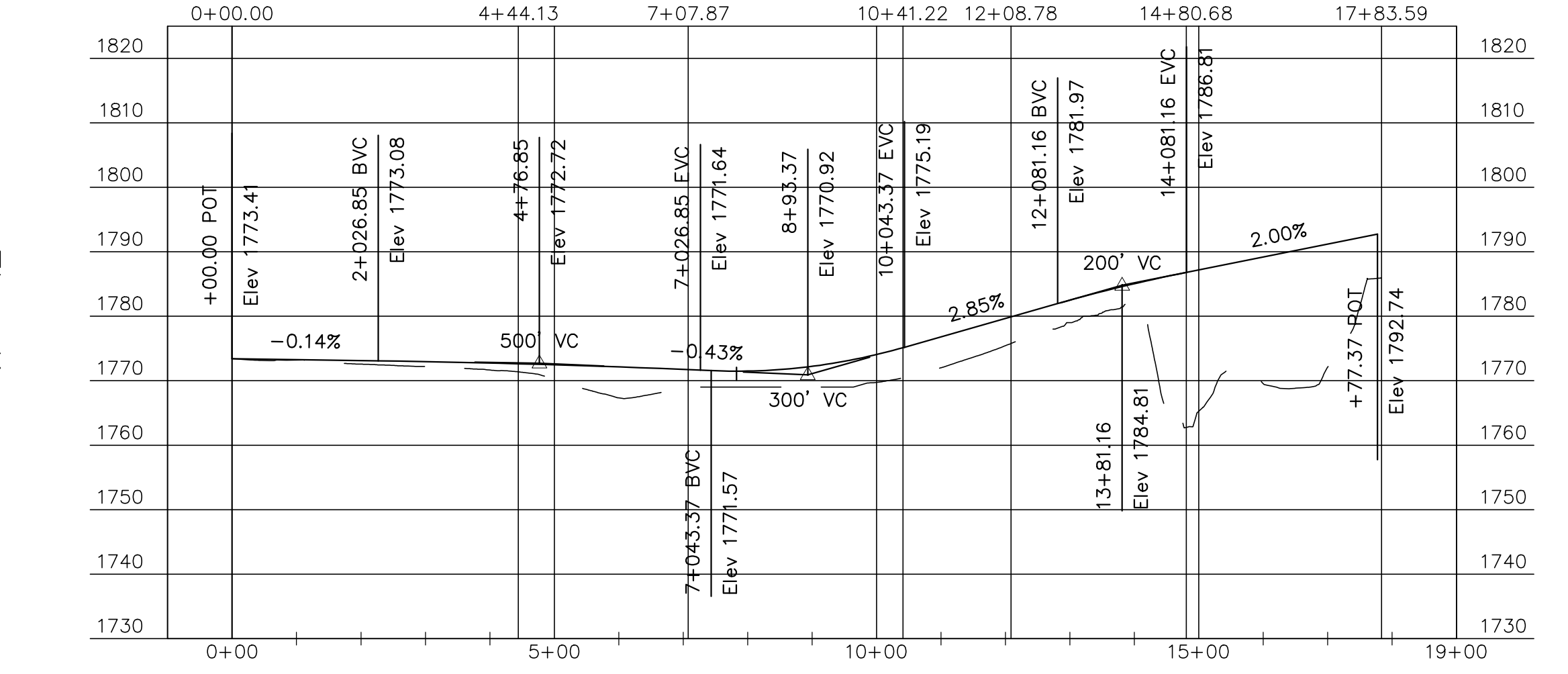

SCALE
Horiz. 1"=200'
Vert. 1"=20'

SUPERELEVATION - EASTBOUND ON-RAMP

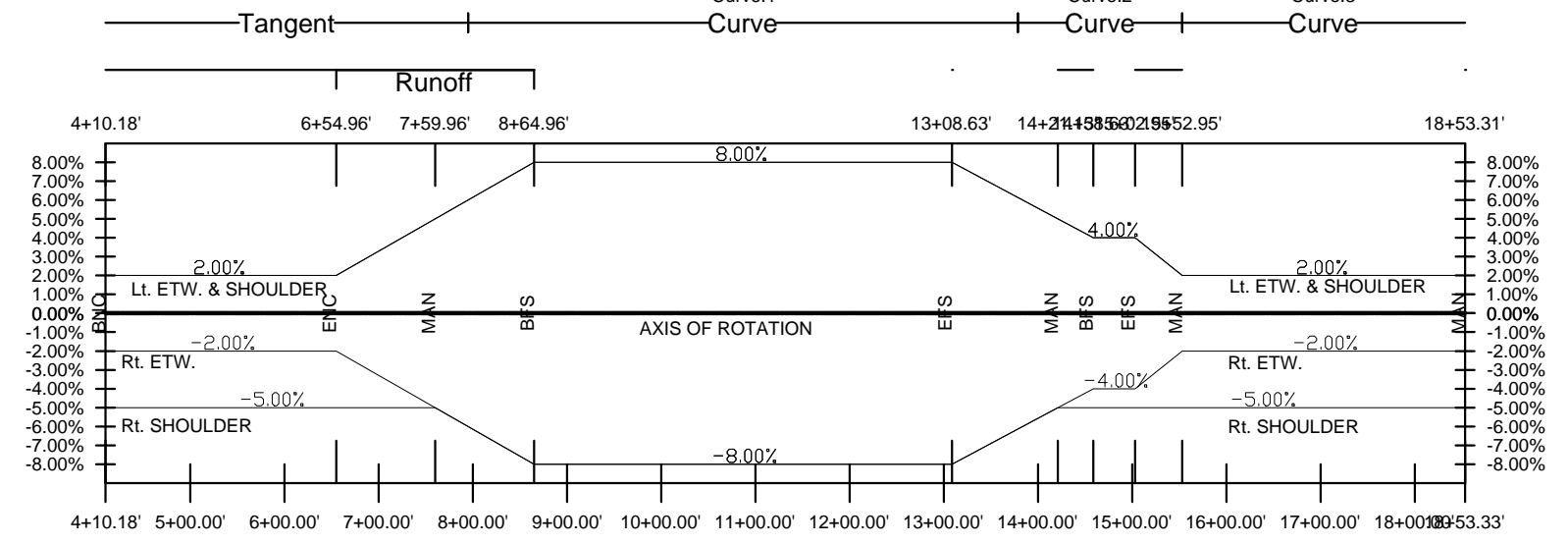

PROFILE - EASTBOUND ON-RAMP

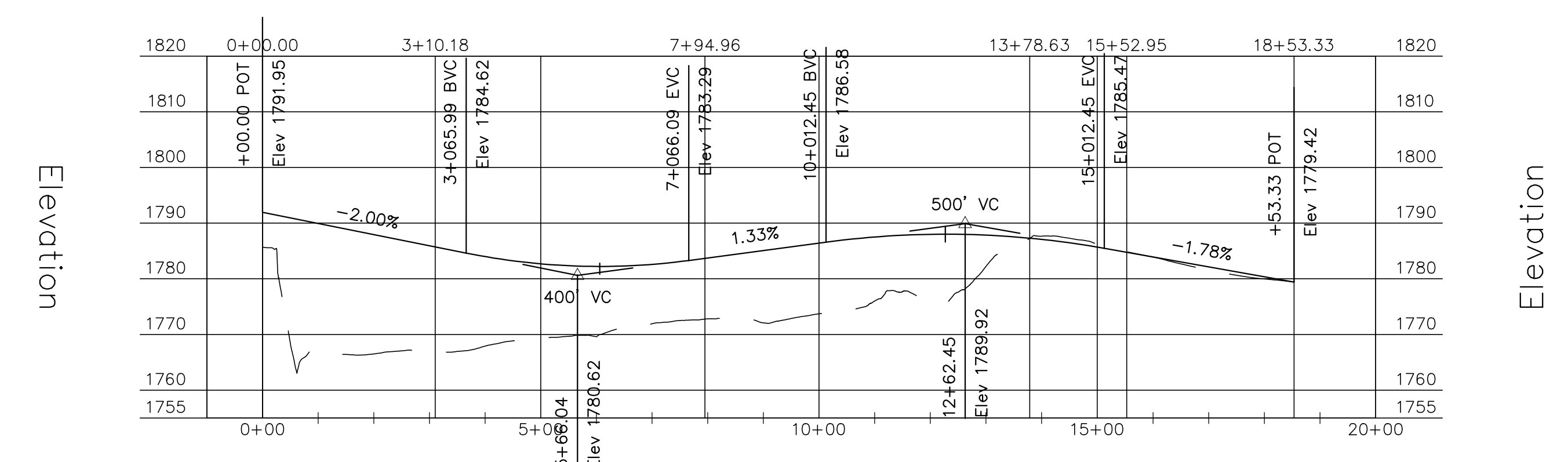

SCALE
Horiz. 1"=200'
Vert. 1"=20'

ALTERNATIVE 3
DIVERGING DIAMOND

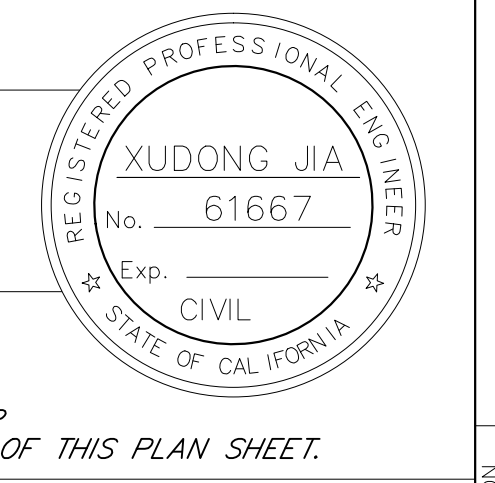

PROJECT ENGINEER REGISTERED CIVIL ENGINEER DATE XUDONG JIA No. 61667 CIVIL STATE OF CALIFORNIA

PLANS APPROVAL DATE THE STATE OF CALIFORNIA OR ITS OFFICERS OR AGENTS SHALL NOT BE RESPONSIBLE FOR THE ACCURACY OR COMPLETENESS OF SCANNED COPIES OF THIS PLAN SHEET. CONTRACT No. 00-000004 PROJECT ID 0000000000